

THE OPEN HOUSE RESOURCE GUIDE

An overview of the innovative and one-of-a-kind home presented in



MAKING ROOM

Housing for a Changing America

An exhibition on view November 18, 2017 through January 6, 2019

Making Room explores new design solutions for the nation's evolving, 21st-century households. From tiny houses to accessory apartments, cohousing, and beyond, all of the featured projects—including The Open House—push past standard choices and layouts.

Organized by



In partnership with





MAKING ROOM focuses a much needed spotlight on the mismatch between the diversity of our households and the homogeneity of our housing.

The Open House is the centerpiece of the exhibition and demonstrates how thoughtful and flexible design solutions can transform how we live.

Designed by architect Pierluigi Colombo, The Open House expertly addresses the needs of three prototypical—and increasingly common—households: roommates, a multigenerational family, and empty nesters. The 1,000-square-foot home features a hyper-efficient layout, smart technologies, movable walls, and multifunctional furniture.

The Roommates

On view November 18, 2017 to late February, 2018

To accommodate a roommate household—in this case, a couple and two single adults—the layout of The Open House maximizes private space. When the moveable walls are fully closed, each roommate has complete privacy; when fully retracted, with the touch of a button, bedrooms can be combined to create a larger room for socializing. The couple shares one bathroom while the roommates share the other, and they all use the communal kitchen. Each bedroom, including the larger one shared by the couple, is outfitted with a space-saving wall bed and built-in storage.



The Extended Family

On view March to late May, 2018

To meet the needs of a multigenerational household, The Open House accommodates living communally, but with flexibility. In this scenario, a grandmother lives with her adult daughter and grandson. During the day, the moveable walls can be open to share living spaces—although the grandmother’s space is tucked away if she wants to retreat. In the evening, the moveable walls allow them to carve out a dedicated bedroom for the grandson. This allows the adults to move freely throughout the rest of the space when the child is asleep, and even entertain.

The Empty Nesters

On view June 2018 to January 6, 2019

To serve a two-in-one household, The Open House seamlessly becomes two independent homes. Here, an older couple who want to stay in their existing home can nevertheless downsize by converting the largest bedroom into a self-contained studio apartment. They can rent out the apartment for additional income, provide the space to a live-in caregiver, or welcome home any of their adult children. Each unit has its own entrance, full bath, and kitchen area. The couple's no-step, walk-in shower has retractable walls which can free up floor space should either of them need a walker or wheelchair. Likewise, the kitchen's fixtures, cabinetry, and appliances have been optimized for a limited range of motion.



The footprint and key features of The Open House will remain constant throughout the exhibition's run, and include:

- an eat-in kitchen designed for varying ages and abilities, with countertops and sinks at two heights, and plenty of accessible storage
- 2 full baths with fixtures and fittings chosen for flexibility and ease of use
- 3 living areas outfitted with transformative furniture allowing each space to double as a private bedroom
- a walk-in closet with a pocket-door that incorporates storage
- a walk-in laundry room
- movable walls
- an integrated smart home network

The Open House has been designed to meet the District of Columbia's residential building code, as well as follow the general guidelines set forth in the Americans with Disabilities Act.

All renderings courtesy Resource Furniture and Clei.

In-kind product contributors to The Open House

AJ Madison | ajmadison.com

Appliance authority offering top-rated brands, including Miele, Electrolux, and Elica

Andersen Corporation | andersencorporation.com

Largest window and door manufacturer in North America

Benjamin Moore & Co. | benjaminmoore.com

Manufacturer of premium paints and finishes since 1883

Capitol Closet Design | capitolclosetdesign.net

Custom closet design and home storage organization systems

Casaplex | casaplex.com

Creators of smart buildings and integrated smart home networks

Ceramics of Italy | ceramica.info/en

Trade organization representing the Italian tile industry

Cerno | cernogroup.com

Designer and manufacturer of modern, U.S.-made LED lighting fixtures and furniture

Clei | clei.it

Designer and manufacturer of transforming and multifunctional furniture since 1962

ConcreteWall | concretewall.no

High-resolution, custom-made, photographic wallcoverings

EastBanc, Inc. | eastbanc.com

Multinational real estate development firm

Ernest Rust - European Kitchens | ernestrust.com

European kitchen designer and manufacturer based in Pludry, Poland

FLOR | flor.com

Modular carpet squares and area rugs for residential and commercial spaces

Geberit | geberitnorthamerica.com

European market leader in high-end sanitary technology and products

Ginger | gingerco.com

Designer and manufacturer of solid forged brass bathroom accessories, lighting, and mirrors since 1983

Häfele America Co. | hafele.com

Leading international source of furniture fittings and architectural hardware

Hansgrohe | hansgrohe-usa.com

Leading manufacturer of bathroom and kitchen fixtures, faucets, and accessories since 1901

Hufcor | hufcor.com

World leader offering the widest range of glass, operable, vertical lift, and accordion partitions

In2Green | in2green.com

Manufacturer of eco luxury throws and accessories knit in the USA

Neoscape | neoscape.com

Creative agency specializing in the built environment

Newfloor | newfloor.net/en

Manufacturer of raised access flooring systems made in Italy for internal and external applications

Precision Door and Hardware | pdoor.com

Supplier of commercial doors, frames, and hardware to the Mid-Atlantic region

Protek | protek-controtelai.com/en/home

Designer and manufacturer of sliding and swing doors, in-wall storage systems, and modular furniture

Resource Furniture | resourcefurniture.com

Importer, distributor, and retailer of modern space-saving furniture from European designers

Vaghi | vaghi.com

Specialists in office and contract seating designed and made in Italy since 1964

The Open House is presented in partnership with Resource Furniture, Clei, and architect Pierluigi Colombo.

Clei

Pierluigi Colombo and Roberta Colombo

Resource Furniture

Ron Barth, Steve Spett, Lisa Blecker, Kirk Schuly, Challie Stillman, Sam Vider, Maria Claudia Narvaez Arango, and Pieter Depreeuw

National Building Museum and Citizens Housing & Planning Council

Chrysanthe Broikos, Sarah Watson, Caitlin Bristol, Zachary Paul Levine, Vlad Zabavskiy, Leslie Chung, Hank Griffith, Christopher Maclay, Nancy Bateman, Laura Hicken and Marcus Collins

ASID Consulting Design Committee

Susan Chung, Ph.D. and Tiffany Westover-Kernan, American Society of Interior Designers
Annie Drury, ASID, FORRESTPERKINS
Bridget McMullin, ASID, NCIDQ, CID, CAPS, The McMullin Design Group
Thea Scott-Fundling, AIA, ASID, LEED AP, Marymount University



MAKING ROOM is generously supported by

AARP Foundation[®]
For a future without senior poverty.

Andersen^{CORPORATION} 

 **HUFCOR**[™]
shaping your experience

 NATIONAL
ASSOCIATION of
REALTORS[®]

NEOSCAPE

Additional support is provided by

American Society of Interior Designers Foundation; AJ Madison, Electrolux, Elica, and Miele; Ceramics of Italy; Ditto Residential; Nixon Peabody LLP; Wells Fargo Housing Foundation; Arris Apartments; Casaplex; Ernest Rust - European Kitchens; LISC; Protek; Wiencek + Associates Architects + Planners DC, LLP; and CHPC partners: Curtis + Ginsberg Architects, Dattner Architects, FXFOWLE, SLCE Architects, GF55 Partners, and RKTB

In-kind support is provided by

Resource Furniture and Clei; AJ Madison, Electrolux, Elica, and Miele; Andersen Corporation; Benjamin Moore & Co.; Capitol Closet Design; Casaplex; Ceramics of Italy, Caesar Ceramiche, Ceramica Vogue, Ergon, Gruppo Romani, MAPEI, and Tagina; Cerno; Duravit USA, Inc.; EastBanc, Inc.; Ernest Rust - European Kitchens; FLOR; Geberit; GINGER; Häfele America Co.; Hansgrohe; Hufcor; In2Green; Neoscape; Newfloor; Novità Communications; Opticos Design, Inc; Precision Door and Hardware; Protek; The Joyce Agency; and Vaghi

Making Room: Housing for a Changing America

November 18, 2017–January 6, 2019

Visit go.nbm.org/MakingRoom for more information, related programming, and additional content.

Museum Hours

Monday–Saturday, 10 am–5 pm; Sunday, 11 am–5 pm

Admission

Free access to the Great Hall, historic building tours, Museum Shop, and cafe.

Exhibition admission:

\$10 for adults

\$7 for youth, students, and seniors

Free for Museum members

Membership

Museum membership offers such privileges as free exhibition admission; invitations to special events; and discounts on Museum Shop purchases, public programs, and tours.

Museum Shop

The Museum Shop, located on the ground floor, is Washington's finest source of design- and building-related books and gifts, including jewelry, home furnishings, toys, and games. Museum members receive a discount on all purchases.

About Us

The **National Building Museum** inspires curiosity about the world we design and build. We believe that understanding the history and impact of architecture, engineering, landscape architecture, construction, and design is important for all ages. Through exhibitions and educational programs, we show how the built world has power to shape our lives, communities, and futures.

 Public inquiries: 202.272.2448 or visit www.nbm.org



@BuildingMuseum

@NationalBuildingMuseum

www.facebook.com/NationalBuildingMuseum

401 F  Street, NW, Washington, D.C. 20001

Metro:    Judiciary Square

Gallery Place-Chinatown

THE ROOMMATES

On view November 18, 2017 to late February, 2018

To accommodate a roommate household—in this case a couple and two single adults—the layout of The Open House maximizes private space.



THE EXTENDED FAMILY

On view March to late May, 2018

To meet the needs of a multi generational household, The Open House accommodates the living communally, but with flexibility.

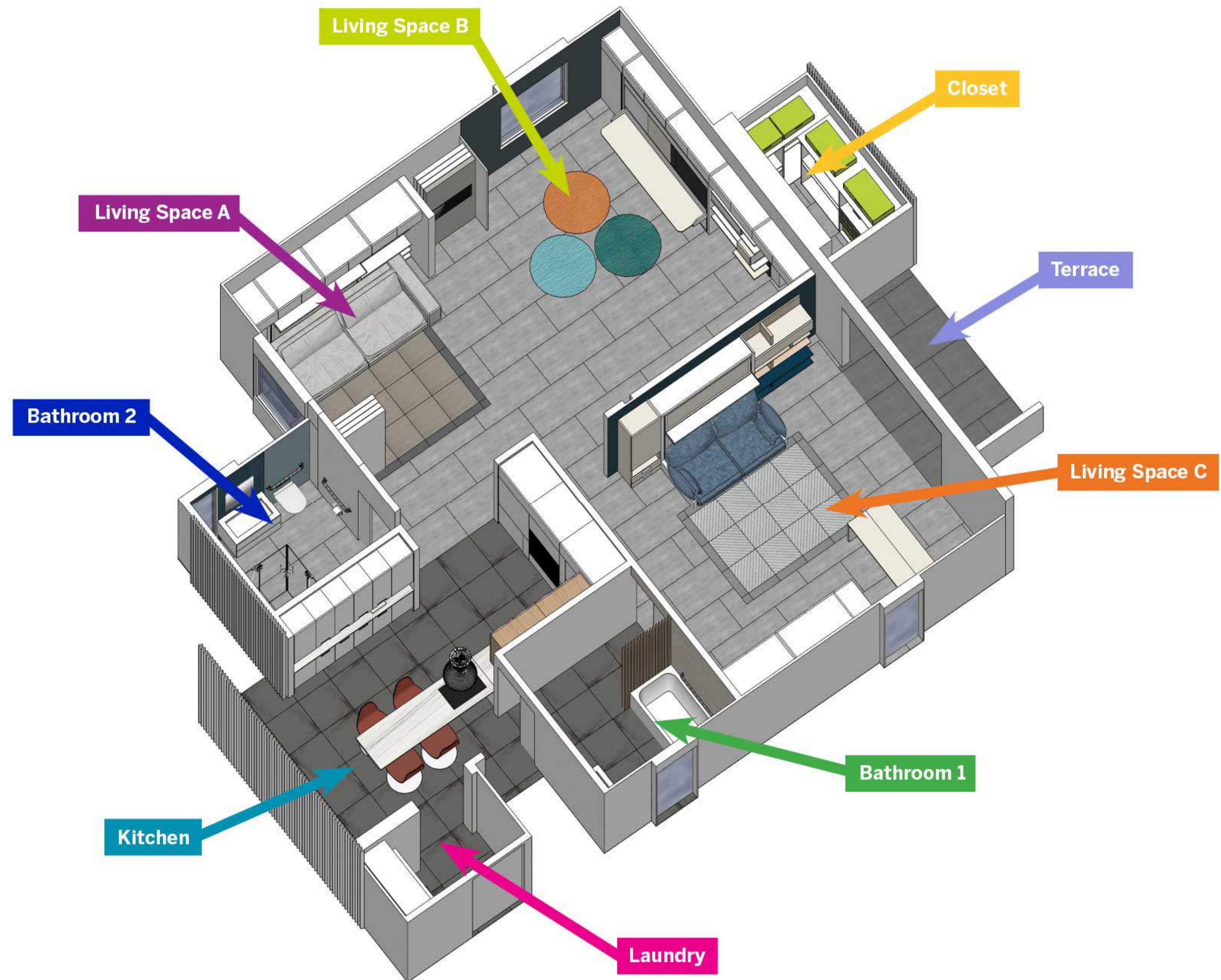

THE EMPTY NESTERS

On view June 2018 to January 6, 2019

To serve a two-in-one household, The Open House seamlessly becomes two independent homes.



Materials, Products, and Furniture featured in The Open House

AJ Madison

- Miele MasterCool™ Refrigerator/Freezer, Model KF 1813 Vi
- Miele Convection Oven, Model H 6880 BP
- Miele Induction Cooktop with PowerFlex Cooking Area, Model KM 6360
- Miele Warming Drawer, Model ESW 6880
- Miele ADA-Compliant Dishwasher with Knock2open Door, Model G 6880 SCVi K20 AM
- Elica Platinum Range Hood, Model EPL32055, stainless steel finish
- Electrolux Front Load Washer, Model WEFLS210TIS, titanium finish
- Electrolux Ventless Electric Dryer, Model EFDE210TIS, titanium finish

Andersen Corporation

- 100 Series Fibrex Composite Windows (casement, picture, and specialty) with Low E Obscure Glass, and Low E Tempered Glass for the bathrooms

Benjamin Moore & Co.

- HC-60 Queen Anne Pink, HC-157 Narragansett Green, HC-169 Coventry Grey, HC-171 Wickham Grey, 2062-20 Gentlemen's Grey, 2089-10 Iron Ore Red, 2136-40 Aegean Teal, 2131-50 Nimbus Grey

Capitol Closet Design

- Northern Contours Drawer Faces and Doors, Tafisa Sommet™ Series Shelving and Cabinet Frames, weekend getaway finish
- Custom Cabinetry: Washer/Dryer Pedestal with Pull-Out Step, Upper Storage Cabinet with LED Lighting, Northern Contours Drawer Faces and Doors, Tafisa Sommet™ Series Shelving and Cabinet Frames, winter fun finish

Casaplex

- Interlogix Pet Immune SAW PIR Motion Sensors
- Sonance PS-P43T Pendant Speakers
- Crestron® TSW-1060 Touch Panels
- Axis M3045-V Network Camera
- Seura Entertainment TV Mirror
- Equipment: Crestron® DM-MD8X8 Digital Media Video Switcher; Crestron® SWAMP 24X8 Sonnex Multi Room Audio System; Crestron® MC3 3 Series Control Processor; Middle Atlantic 5-21 Space Slim Rack

Ceramics of Italy

- Ergon (Emilgroup) / Collection TR3ND, Porcelain Floor Tile, color: grey wood
- Caesar Ceramiche / Collection One, Terracotta-cement effect Porcelain Tile, color: ground
- CIR (Gruppo Romani) / Collection MAT, Porcelain Tile, color: cloud and sky
- Mapei / Keracolor U 93 Warm Gray Grout, Mapesil T 93 Silicon Sealant, Ultraflex 3 polymer-modified thin-set mortar
- Ceramica Vogue (Altaeco) / Collection Graph, Glazed Ceramic Tile, colors: GP026, GP028, and GP029
- Mapei / Keracolor U 113 Brick Red Grout, Mapesil T 113 Silicon Sealant, Ultraflex 3 polymer-modified thin-set mortar
- Tagina / Collection Apogeo 14, Porcelain Floor Tile, color: anthracite

Cerno

- Capio S LED Wall Sconce, dark stained walnut
- Macto LED Task Lamp, dark stained walnut
- Silva LED Floor Lamp, walnut/ebony veneer

Clei / Resource Furniture

- Oslo 173 Sofa/Queen Wall Bed System and Storage Unit (Scenario 1)
- Tango Sofa/Queen Wall Bed System and Storage Unit (Scenario 2)
- Kali Duo Board Desk/Twin Bunk Bed System and Storage Unit (Scenario 3)
- Plurimo Table (Scenario 3)
- Penelope 2 Sofa/Queen Wall Bed and Storage Unit (Scenario 1)
- Kali Duo Board Desk/Twin Bunk Bed System and Storage Unit (Scenario 2)
- Penelope 2 Motorized Sofa/Queen Wall Bed and Storage Unit (Scenario 3)
- Goliath transforming console/dining table
- Botanicals high-res wallcovering (Scenario 3)
- Oslo 301 Sofa/Queen Wall Bed System and Storage Unit (Scenario 1)
- Nuovoliola Sofa/Queen Wall Bed System and Storage Unit (Scenario 2)
- Penelope 2 Sofa/Queen Wall Bed System and Storage Unit (Scenario 3)
- Kitchen Box modular kitchen (Scenario 3)
- Giro Console Table
- Pocket folding chairs
- Giralot storage unit

Duravit

- Architec Bathtub, Model 700355
- ME by Philippe Starck One-Piece Rimless® Toilet, Model 2173012085
- P3 Comforts Furniture Washbasin, Model 233265 (Phoenix Design)
- L-Cube Vanity Unit, Wall-Mounted, Model LC624403131 (Designer: Christian Werner) pine silver finish
- Delos Wall Mounted Mirror Cabinet, Model DL7541 (EOOS Design)
- OpenSpace B Shower Screen, Model 770012 (EOOS Design)
- ME by Philippe Starck Wall-Mounted Rimless® Toilet, Model 2529590092
- ME by Philippe Starck Furniture Washbasin, Model 233663
- L-Cube Vanity Unit, Wall-Mounted, Model LC624001818 (Designer: Christian Werner) white matte finish
- L-Cube Wall Mounted Mirror Cabinet, Model LC7550 (Designer: Christian Werner)
- P3 Comforts Stool, Model 791877 (Phoenix Design)

Ernest Rust - European Kitchens

- Kitchen Cabinetry, Model R5 Matte finish with stainless steel hardware, AVENTOS HF Bi-fold Door System, Touch-to-Open and Blumotion soft-close Mechanisms; Blum Servo-Drive electric drawers; Peka iMove pull-down shelving; Legrabox Drawers with Ambia-Line Dividers; and Häfele LED Lighting for cabinets, shelves, and handles
- Rust/Hoder Height-Adjustable Counter/Dining Table with Built-In Induction Cooktop
- Rust/Hoder Sink with Electronically Raised Bottom
- Rust Hidden Drop-Down TV System
- Hoder Integrated Wireless Charging Station
- Rust Integrated Counter Scale

FLOR

- Tweed Indeed Carpet Squares, pearl
- Roadside Attraction Carpet Square, frost
- Suit Yourself Carpet Squares, pumice

Geberit

- Dual Flush Actuator, Model 115883KH1
- Concealed In-Wall Tank System, Model 111798001 and Sink Carriers

Ginger

- Kubic Shower Rod and Grab Bars, polished chrome finish
- Lineal Grab Bars, brushed nickel finish

Häfele America Co.

- Synergy Elite Waterfall Hook, Wire Basket, Wardrobe Pin, Valet Rod, Heavy Duty Glide For Pull-out Step, LED Lighting
- Motorized Wardrobe Lift, Engage Pull-out Hamper, Pull-out Shelf, Engage Fabric Drawer, Storage Boxes; Synergy Elite Tie Rack, Belt Rack, Valet Rod, Valet Pin, LED Lighting w/ Motion Sensor and Remote Control

Hansgrohe

- Axor Citterio 2-Spray Prep Kitchen Faucet, Model 39836801, steel optic finish
- Axor Citterio Bar Faucet, Model 39851801, steel optic finish
- Talis S, Select S 100 Single-Hole Faucet, Model 72042001, chrome finish
- S Tub Spout, Model 14413001, chrome finish
- Raindance Select S 120 AIR 3-Jet Hand Shower, Model 26531001, chrome finish
- Raindance Unica S Wall Bar, Model 28632000, chrome finish
- ShowerSelect Round Thermostatic 2-Function Trim, Model 15743001, chrome finish
- Logis S/E series towel bar and accessories, chrome finish
- Talis E, Select E 110 Single-Hole Faucet, Model 71750821, brushed nickel finish
- Raindance Select E 120 AIR 3-Jet Hand Shower, Model 26521821, brushed nickel finish
- Raindance Unica S Wall Bar, Model 28632820, brushed nickel finish
- ShowerSelect Square Thermostatic 1-Function Trim, Model 15762821, brushed nickel finish
- Logis S/E series towel bar and accessories, brushed nickel finish

Hufcor

- 631T Series Telescoping Sliding Wall with Unispan Self-Supporting Truss and Integrated TV Monitor, Carnegie Xorel Fabric, colors: Meteor 718, 737, and 766
- 633E Series Motorized Partition Wall System with Unispan Self-Supporting Truss and Integrated TV Monitor, Carnegie Xorel Fabric, colors: Meteor 726, 759, and 766

In2Green

- Eco Woven Throw, made on vintage looms using recycled cotton/polyester yarns

Newfloor

- Raised Access Flooring system with integrated porcelain tile and SNF steel support structure

Precision Door and Hardware

- Flush Door Pull, Model Rockwood BF97L, satin nickel finish

Protek Design

- Bigfoot® Openspace Linear: Ironing Board/Laundry Center module (Designer: Giovanni Maggioni)
- Linear® Sliding, complete pocket frame door system (Designer: Giovanni Maggioni)
- Bigfoot® Openspace Linear: Shoe Rack Module with mirror and LED lighting, fenix black ingo laminate finish (Designer: Giovanni Maggioni)
- Linear® Swing, complete pivot door system kit for flush wall door (Designer: Giovanni Maggioni)

Vaghi

- Wizard height-adjustable, dining-to-counter upholstered chairs on chrome swivel disk base, Aqualclean Velvet 13 fabric